



2024031652

NOTICE NC
RECORDING FEES

\$0.00

PRESENTED & RECORDED:

10-03-2024 09:01:53 AM

BK: RB 21544

PG: 136 - 139

ANGIE M BRYANT
CLERK OF COURT
YORK COUNTY, SC
BY: REGINA PRUITT CLERK

THE STATE OF SOUTH CAROLINA

COUNTY OF YORK

PERMISSION FOR:

Erosion Control

Slope

York County PID No. 17228-004

Project Name: S-49 (S Sutton Rd) / SC 460 (Fort Mill Pkwy) and US 21 (Highway 21) Widening

Tract No. 020A

PID No. P037952

KNOW ALL MEN BY THESE PRESENTS, That I (or we) **CCC Elizabeth Commons, LLC**, A North Carolina limited liability company— 3605 Glenwood Avenue Suite ⁴⁴⁵500, Raleigh, NC 27612 in consideration of the sum of One Dollar (\$1.00), to me (or us) in hand paid, and other valuable consideration at and before the sealing and delivering hereof, do hereby grant to the County of York permission to do the work as outlined below, with the understanding that this work is to be done on property of the Grantor outside of the right of way, it being fully understood and agreed that no right of way is being granted to the County for the purpose of this construction.

SPECIAL PROVISIONS:

Herein granted is permission for construction slopes to extend beyond the right of way on the left between approximate survey stations 99+75 and 101+00 with the understanding that no additional property is granted for construction slopes, during this construction.

Also Herein granted is permission to use heavy equipment for clearing, placement, maintenance, and access for the purpose of construction of a silt fence for NPDES (National Pollutant Discharge Elimination System) to extend beyond the right of way right of SC 460 (Fort Mill Pkwy), between approximate survey stations 90+00 and 90+50 as shown on the plans for this project with the understanding no additional property is granted for the permission, in accordance with Department standards.

Checked _____ By _____

Recorded _____ By _____

Project _____ File _____ Tract **020A**

TO HAVE AND TO HOLD, all and singular, the said Permission hereinbefore granted, unto the said County of York.

IN WITNESS WHEREOF, I (or we) have hereunto set my (or our) hand(s) and seal(s) this 6th day of February, in the year of our Lord, Two Thousand and Twenty-Four.

Signed, sealed and delivered in the presence of

Thomas N. Massey
1st Witness (can not be Notary)
Barry D Mann
2nd Witness (can be Notary)

CCC Elizabeth Commons, LLC a North Carolina limited liability company
By: Chaucer Creek Capital LLC, a NC LLC, Manager
By William M. McClatchey, Jr. (L.S.)
Manager
Its Manager

NOTE: All right-of-way agreements or easements must be in writing and are subject to rejection by the County of York.

THE STATE OF NORTH CAROLINA)
COUNTY OF WAKE) Acknowledgement

Personally appeared before me the above named Grantor(s) and acknowledged the due execution of the foregoing instrument.

Witness my hand and seal this 6th day of February, 2024

Barry D Mann
Signature of Notary Public
BARRY D. MANN
Printed Name of Notary Public

NOTARY PUBLIC FOR THE STATE OF NORTH CAROLINA
My Commission Expires: 03/17/24
(Affix seal if outside SC)

BARRY D. MANN
NOTARY PUBLIC
WAKE COUNTY, N.C.
My Commission Expires 03-17-2024.

Checked _____ By _____
Recorded _____ By _____
Project _____ File _____ Tract 020A

EXHIBIT "A"

THIS EXHIBIT IS A GRAPHIC REPRESENTATION OF THE "AREA OF ACQUISITION" AND IS IN DIRECT REFERENCE TO ENGINEERING PLANS, A COPY OF WHICH CAN BE OBTAINED FROM SCDOT HEADQUARTERS, 855 PARK STREET, COLUMBIA, SC 29201. ADDITIONALLY, UPON COMPLETION OF CONSTRUCTION, A RECORDABLE RIGHT-OF-WAY PLAT SHALL BE SUBMITTED TO THE REGISTER OF DEEDS IN COMPLIANCE WITH SCDOT STANDARD DRAWING 809-105-00.

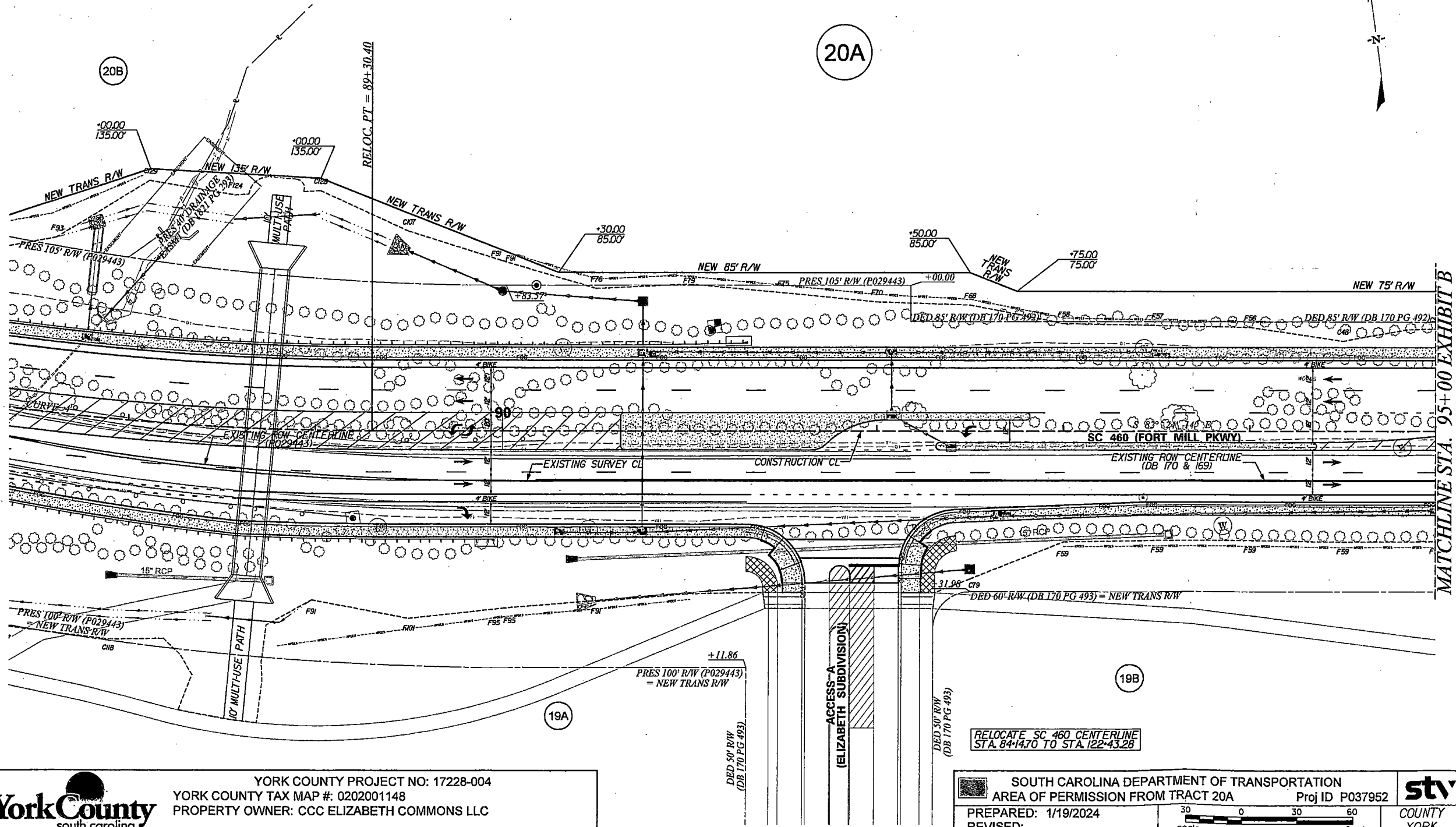

20A

20B

19A

19B

MATCHLINE STA. 95+00 EXHIBIT B

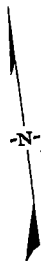

YORK COUNTY PROJECT NO: 17228-004
 YORK COUNTY TAX MAP #: 0202001148
 PROPERTY OWNER: CCC ELIZABETH COMMONS LLC

RB BK 21544 PG 138

SOUTH CAROLINA DEPARTMENT OF TRANSPORTATION
 AREA OF PERMISSION FROM TRACT 20A
 Proj ID P037952
 PREPARED: 1/19/2024
 REVISED:

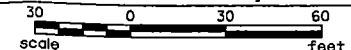

Page ___ of ___ pages

EXHIBIT " B "

THIS EXHIBIT IS A GRAPHIC REPRESENTATION OF THE "AREA OF ACQUISITION" AND IS IN DIRECT REFERENCE TO ENGINEERING PLANS, A COPY OF WHICH CAN BE OBTAINED FROM SCDOT HEADQUARTERS, 955 PARK STREET, COLUMBIA, SC 29201. ADDITIONALLY, UPON COMPLETION OF CONSTRUCTION, A RECORDABLE RIGHT-OF-WAY PLAT SHALL BE SUBMITTED TO THE REGISTER OF DEEDS IN COMPLIANCE WITH SCDOT STANDARD DRAWING 809-105-00.

MATCHLINE STA 95+00 EXHIBIT A

20A

20

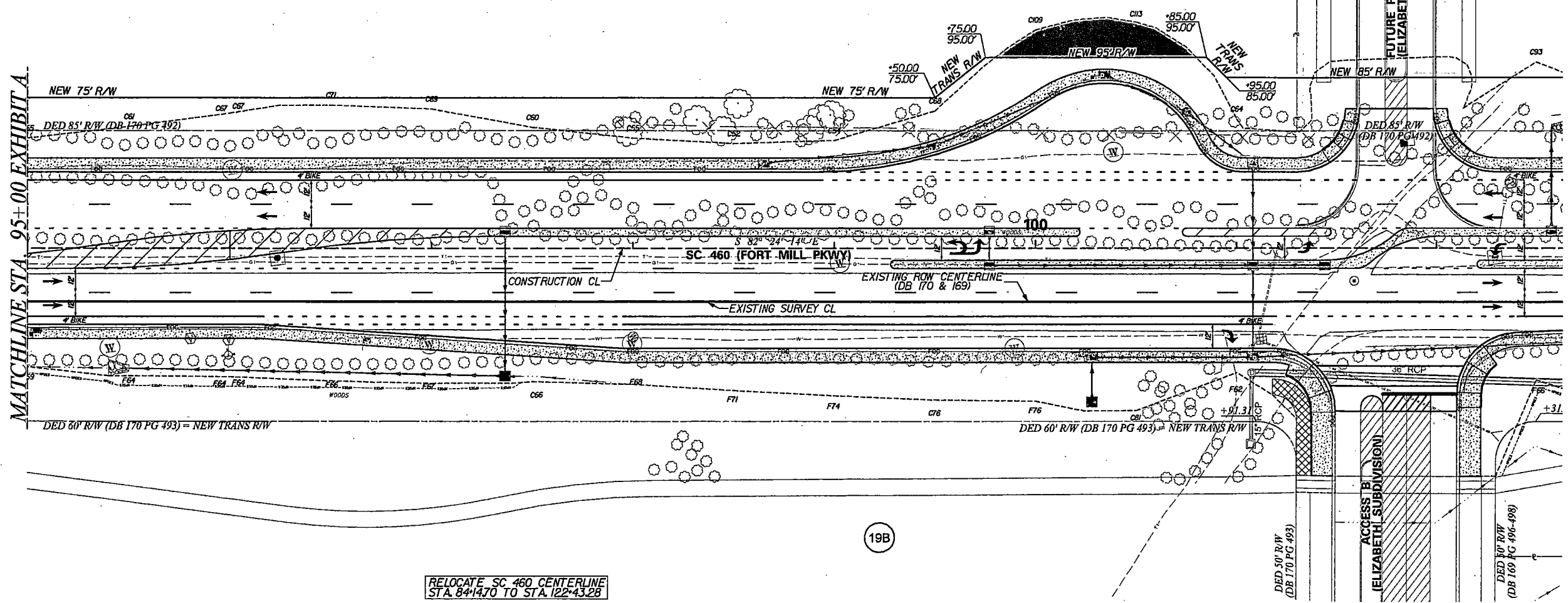
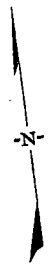

RELOCATE SC 460 CENTERLINE
STA. 84+14.70 TO STA. 122+43.28

19B



YORK COUNTY PROJECT NO: 17228-004
YORK COUNTY TAX MAP #: 0202001148
PROPERTY OWNER: CCC ELIZABETH COMMONS LLC

SOUTH CAROLINA DEPARTMENT OF TRANSPORTATION AREA OF PERMISSION FROM TRACT 20A Proj ID P037952			
PREPARED: 1/19/2024 REVISED:	COUNTY YORK		